

# SETUP AND MAINTENANCE GUIDE

## Catalytic Reverse Osmosis System



**Commercial 3 Stage  
Catalytic RO System 600 GPD  
Product # 738370**



**Commercial 3 Stage  
Catalytic RO System 1200 GPD  
Product # 738375**

# WHAT'S IN THE BOX?



## Commercial Catalytic RO System - 600 GPD



# IDEAL H<sub>2</sub>O® COMMERCIAL CATALYTIC RO 600 GPD PART LIST

## Commercial 3 Stage Catalytic RO 600 GPD System unit includes:

1. Polyspun Sediment Filter - Removes sediment, particulates, dirt and rust.
2. Catalytic Carbon Pre-filter - Removes chlorine, chloramine, odor and other chemicals.
3. Reverse Osmosis Membrane - one 600 GPD filter - removes total dissolved solids.
4. Water Source Inlet Tubing, 3/8" (White) - w/ Garden Hose Connector.
5. Filtered Water Outlet Tubing, 3/8" (Blue).
6. Waste Water Outlet Tubing, 1/4" (Black).
7. Flow Restrictor - reduces the amount of waste water produced from the system, 1:1 clean water to waste water.
8. Shut Off Valve - Allows user to quickly turn off flow of water from the RO system.
9. Filter Wrench - for safe removal of filter housing.

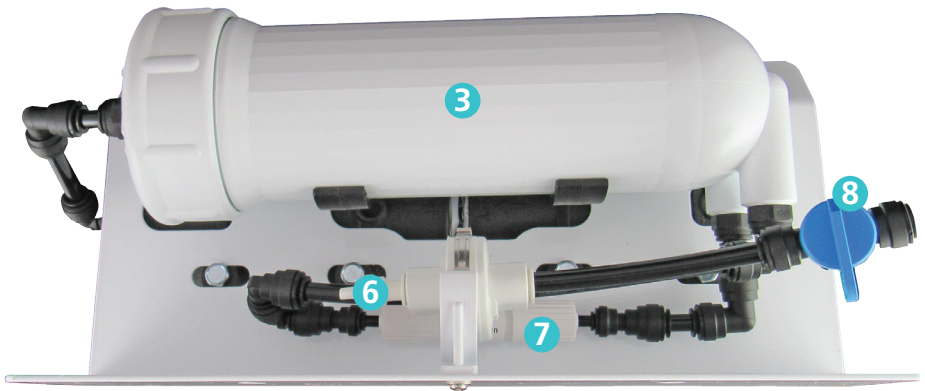

|                |   |
|----------------|---|
| UNIT SIZE      | 16.5" w x 17.75" h and weight: 22.2 lbs.          |
| CAPACITY       | 600 gpd / 25 gph                                  |
| PRESSURE       | Min - 40 psi; Max - 125 psi                       |
| TEMPERATURE    | Min - 40°F; Max - 110°F                           |
| INLET TDS      | Min - 50 ppm; Max - 1000 ppm                      |
| HARDNESS       | Min - 0 grain (0 mg/l); Max - 10 grain (171 mg/l) |
| OPERATING pH   | Min - 3; Max - 11                                 |
| PERMEATE/WASTE | 1 gallon permeate : 1 gallon waste                |
| EFFICIENCY     | 600 gpd @ 70 psi, 77°F, 500 ppm                   |

## Commercial Catalytic RO System - 1200 GPD



## Commercial 3 Stage Catalytic RO 1200 GPD System unit includes:

1. Two (2) -Catalytic Carbon Pre-filter - Removes chlorine, chloramine, odor and other chemicals.
2. Reverse Osmosis Membrane - two 600 GPD filters - removes total dissolved solids.
3. Water Source Inlet Tubing, 3/8" (White) - w/ Garden Hose Connector.
4. Filtered Water Outlet Tubing, 3/8" (Blue).
5. Waste Water Outlet Tubing, 1/4" (Black).
6. Flow Restrictor - reduces the amount of waste water produced from the system, 1:1 clean water to waste water.
7. Shut Off Valve - Allows user to quickly turn off flow of water from the RO system.
8. Filter Wrench - for safe removal of filter housing.

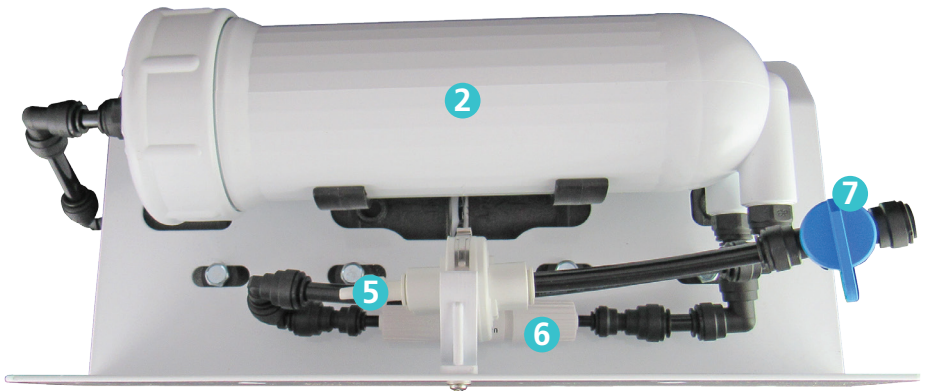

|                |   |
|----------------|---|
| UNIT SIZE      | 16.5" w x 20.75" h and weight: 25.7 lbs.          |
| CAPACITY       | 1200 gpd / 50 gph                                 |
| PRESSURE       | Min - 40 psi; Max - 125 psi                       |
| TEMPERATURE    | Min - 40°F; Max - 110°F                           |
| INLET TDS      | Min - 50 ppm; Max - 1000 ppm                      |
| HARDNESS       | Min - 0 grain (0 mg/l); Max - 10 grain (171 mg/l) |
| OPERATING pH   | Min - 3; Max - 11                                 |
| PERMEATE/WASTE | 1 gallon permeate : 1 gallon waste                |
| EFFICIENCY     | 1200 gpd @ 70 psi, 77°F, 500 ppm                  |

# QUICK OPERATION GUIDE

The following steps will get you set up in just a few minutes. Please read each step carefully. If you have any questions, please refer to our website at [www.IdealH2O.net](http://www.IdealH2O.net) for information and videos on setup & maintenance.

## Step 1 – Check tubing connections on unit:

To prevent any issues with installing your RO system, we have pre-installed all of the tubing in the correct inlet and outlet fittings. However, the tubes may have come loose during shipping. Please double check all tube connections throughout the system. With one hand, hold the fitting while pushing the tubing firmly (**fig. C**). Doing this will prevent leaks in the system.

(fig. C)  
Check all tube  
connections

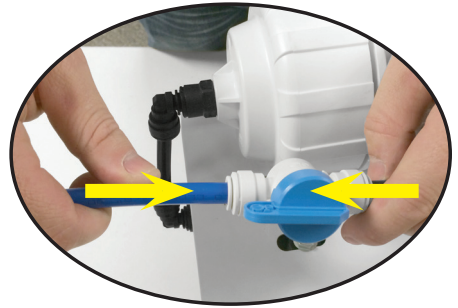
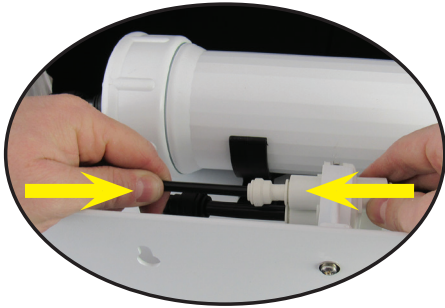

## Step 2 – Starting up your RO System

Connect the white inlet tube to your water supply and slowly turn on the water source. Once the sediment and carbon filter housings have water in them, turn the water supply fully on.

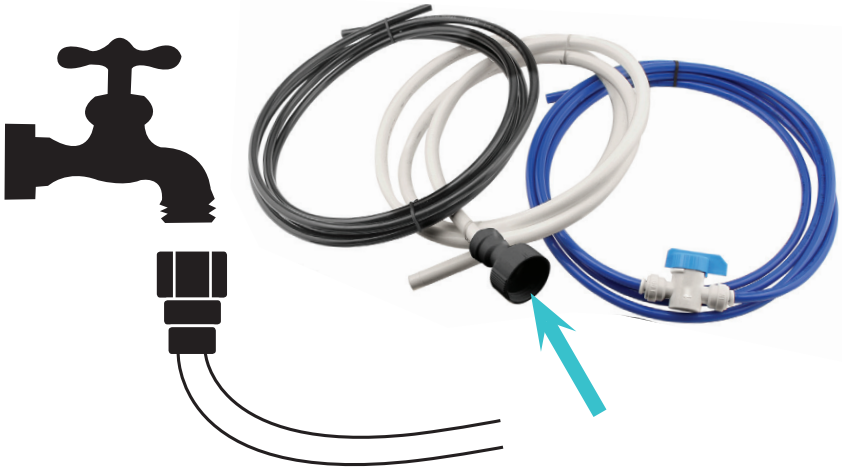

*Allow water to run 30 to 40 minutes to flush the system before use, especially after changing the filters and membranes.*

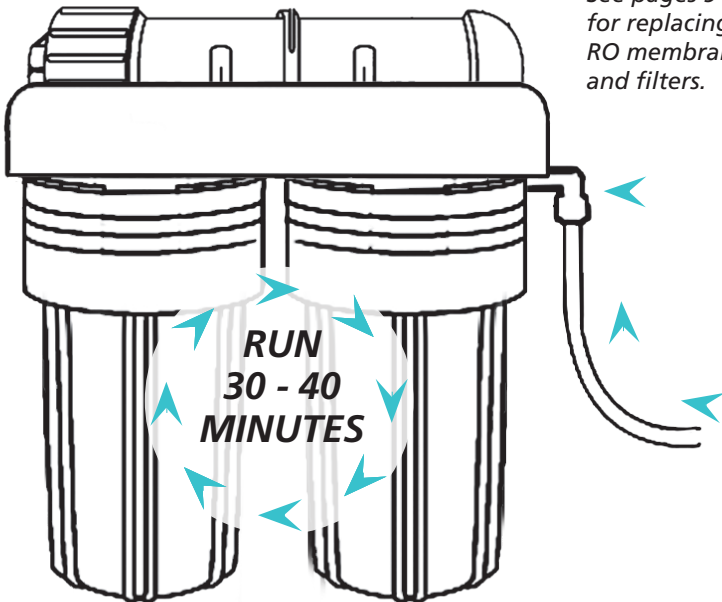

*See pages 9 & 10 for replacing RO membranes and filters.*

# MAINTENANCE AND FILTER CHANGES

The Ideal H2O® Reverse Osmosis Systems have pre-filters that will need to be replaced after a certain time period of use. By keeping up with the replacement of your filters, you can double, or even triple, the life of your RO membrane. This length of time these filters will last is completely dependent on how clean your water source is.

The RO membrane will usually last 6 months to 2.5 years. Again, by changing your pre-filters regularly, the RO membrane will last much longer.

## REPLACING THE RO MEMBRANE

**Step 1** – Disconnect quick connect fittings and unscrew the white cap from the membrane housing.



600 GPD RO Replacement Membrane





**Step 2** – Remove the membrane from the housing with a pair of needle nose pliers. Hold onto the membrane housing while you are pulling the membrane out.



**Step 3** – Insert new membrane into membrane housing and screw the white cap back onto the white membrane housing, making sure the cap is firmly hand tightened (refer to step 1 on page 6).

***Always make sure to run the system for 30 to 40 minutes before use, especially after changing the filters and RO membranes***



# REPLACING THE FILTERS

**Step 1 – Unscrew the filter housing from the RO System using the filter wrench included with your system.**



**Step 2 – Replace sediment and/or carbon filters.**



**Step 3 – Screw the filter housing back onto the RO system, firmly hand tightening these. Do not use the wrench to tighten.**

\* Be cautious of the o-ring. Make sure it does not fall out or pinch.



# REPLACEMENT FILTER INFORMATION



**A**



**B**

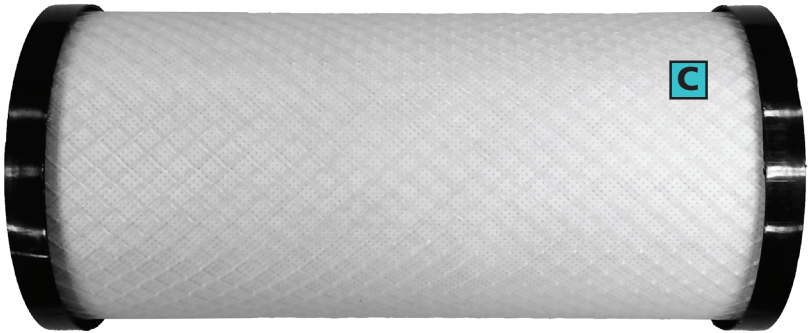

**C**

|          | REPLACEMENT FILTER INFO             | PART NUMBER | FILTER REPLACEMENT TIMELINE |
|----------|-------------------------------------|-------------|-----------------------------|
| <b>A</b> | 600 GPD RO Membrane                 | 738378      | 6 months to 2.5 years       |
| <b>B</b> | Polyspun Sediment Filter - 4.5"x10" | 738356      | 6 to 12 months              |
| <b>C</b> | Catalytic Carbon Filter - 4.5"x10"  | 738380      | 6 to 12 months              |



For all warranty inquiries, please contact  
Ideal H<sub>2</sub>O® at (888) 582-2762.

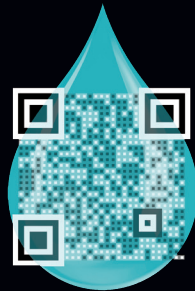

[www.IdealH2O.net](http://www.IdealH2O.net)

Scan this QR code or visit our website for  
how-to videos and other product information.

Exclusively distributed by:



Sunlight Supply® Inc.

[www.sunlightsupply.com](http://www.sunlightsupply.com)

#111385 REV E • 02032017LS