

mondi™



## SAVE THIS MANUAL!

PLEASE READ ALL  
INSTRUCTIONS BEFORE  
USING THIS PRODUCT

GENERAL SAFETY .....	1
INSTALLATION .....	2
OPERATION .....	3
SPECIFICATIONS .....	4
MAINTENANCE & STORAGE	4
TROUBLESHOOTING .....	5
WARRANTY .....	5
EXPANDED VIEW .....	6

# UTILITY & SUMP PUMP 1200 GPH

GOLD SERIES MODEL# C105

OWNER'S MANUAL

## PLEASE READ AND SAVE THESE SAFETY INSTRUCTIONS!



This safety alert symbol will alert you to cautionary measures in the use and operation of this pump, and give you instructions on how to avoid potentially serious personal injury or property damage.

## GENERAL & ELECTRICAL SAFETY

The following directions are included for your safety and the long-life of your MONDI Utility & Sump Pump. Please carefully read and follow all safety instructions in this manual and on the pump. Keep the safety labels in good condition. Replace missing or damaged safety labels.

1. The pump is designed for use with clean or slightly turbid fresh water. Not intended for use in salty/briny water, oil or corrosive liquids.
2. Do not lift pump by power cord - attempting to lift or support the pump by the power cord causes damage to the cord and cord connections, and voids your warranty. Lift the pump by its handle only. If you need to lower the pump into position, use a rope attached to the loop provided above the handle.
3. Follow the **National Electrical Code, Canadian Electrical Code**, and local codes in regards to outlets and voltage for this pump.
4. Installation must comply with all local codes pertaining to utility pumps.
5. Know the pump application, limitations, and potential hazards. See **Specifications** for more information.
6. Disconnect the power source, release all pressure within the system and drain water from the pump before maintenance.
7. Secure the discharge line before starting pump to avoid personal injury and/or property damage due to sudden discharge line movement.
8. Check pump and hoses for weakened or worn condition before each use, and make certain that all connections are secure.
9. Periodically inspect the pump and system components to make sure the inlet is free of debris or foreign objects.

10. Wear protective eye-wear at all times when working with the pump.
11. This equipment is only for use on 110 -120V (single phase) and is equipped with an approved 3-conductor cord and 3-prong, grounding type plug.



**WARNING** Risk of electric shock. This pump is supplied with a grounding conductor and grounding-type attachment plug. To reduce the risk of electric shock, be certain that it is connected only to a properly grounded, grounding-type receptacle. Disconnect plug before servicing. Do not remove the grounding pin under any circumstances - you will void your warranty. The pump is acceptable for outdoor use. This pump has not been investigated for use in a swimming pool.

12. Make certain the power source conforms to requirements of this pump.
13. Protect the electrical cord from sharp objects, hot surfaces, oil, and chemicals. Avoid kinking cord.
14. Do not open the pump casing or motor housing. Warranty void if opened.
15. Disconnect power before handling or inspecting the pump to remove the risk of electric shock.

## INSTALLATION

This submersible pump is designed for use as a utility pump – an oil-less motor system inside does not require lubrication. Please follow the instructions below carefully for the long-life of your pump.

1. Place the pump on a hard level surface, making sure there is no debris that may lodge in the pump inlet. Use a board or piece of metal if needed to raise the pump in the case of muddy/debris covered base. If there is debris in the water, we recommend using a pump filter/pump bag (sold separately) to extend the life of your pump.
2. Protect the power cord from damage. Uncovered cords should be checked at regular intervals to ensure safe operation of the pump. Do not operate the pump if the power cord or plug is damaged. The power cord is not replaceable.

## INSTALLATION PROCESS

1. First, screw the syphon components and Straight pipe components (Fig. 1)
2. Screw the upper connection (pipe components) onto the pump (Fig.2), then you can use the pump

### Note:

The valve is used to regulate the water flow, the screw cap and the linked can be connected through the screw, then you can hang the pump in a proper place (Fig.1) The sieve is used to prevent dirty solid into the pump, that may damage the pump. If necessary, you should clean the sieve from time to time (Fig.3)

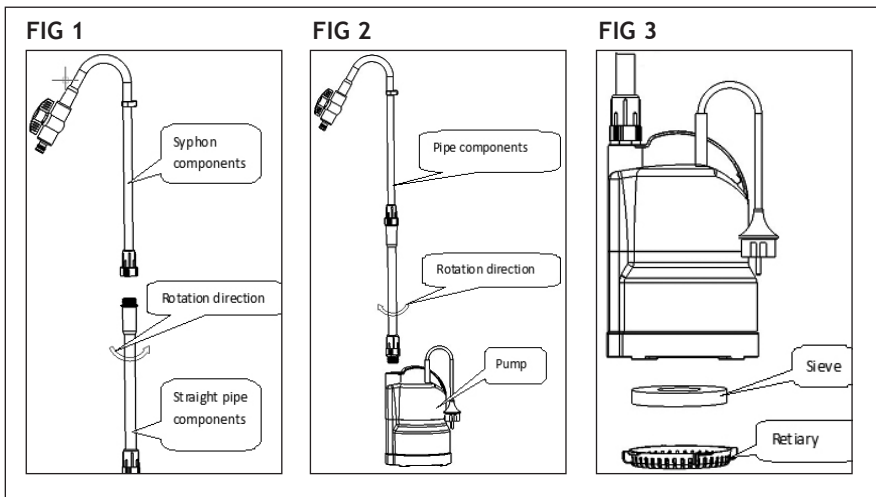

## OPERATION

**WARNING** – Hazardous voltage. Can shock, burn or cause death. Disconnect power before moving or inspecting pump.

1. The pump must be submersed in at least 1'(30cm) of water to operate - for continuous operation, complete submersion is preferable to prevent the motor from overheating.

## GOLD SERIES 1200X

2. The pump will remove water down to 1/2"(1.0cm) in ideal conditions. If the pump is operating and no water comes out of the discharge line, shut off the power immediately. The water level is likely very low and the pump is no longer primed.
3. The pump is designed to pump cool water only. Pumping heated water, or liquids other than water can overheat the motor. Do not pump flammable liquids - there is a risk of explosion.
4. Keep the pump inlet free of debris or foreign material at all times – if required, use a raised base for the pump to sit on (see **Installation 1**).

### SPECIFICATIONS

Max. Head, Max. Height, and Gallons Per Hour at Height are achieved in ideal conditions - your results may vary slightly.

MODEL NUMBER	HP	HZ	MAXIMUM HEAD
Gold Series 1200X	1/6HP	60Hz	36
MAXIMUM FLOW RATE	VOLTS	AMPS	CORD
581 Gal/H	110-120V	3.0	20ft/6.3m

### MAINTENANCE & STORAGE

Always ensure that the pump is operating with adequate water supply. Periodically shut off the power supply and check the pump for debris lodged in the intake grill.

The intake grill may be removed and cleaned by removing the screws underneath the pump housing. The pump's motor is completely sealed in the motor housing and does not require regular service. Disassembly of the motor housing or modification or removal of the power cords voids your warranty. The power cord is non-replaceable.

Make sure the pump is dry and clean before storing. Retain the original packaging for the purpose of storing your pump. Always store your pump in a cool dry place. Never store it while it is still connected to power. Do not stress the cord by wrapping it too tightly around the pump, as it could cause the cord to eventually fray and break down. DO NOT store in water. When re-using the pump, please re-read the instructions.

## TROUBLESHOOTING

SYMPTOMS	POSSIBLE CAUSES	SOLUTION
Pump does not start	Blown fuse/circuit breaker has tripped	If fuse is blown, replace with new fuse/reset circuit breaker
	Low line voltage	Check size of wiring from main switch on property/contact your local power authority
	Defective motor	Contact Dealer
Pump operates but pumps very little or no water	Low line voltage	Check size of wiring from main switch on property/contact your local power authority
	Debris caught in impeller	Contact Dealer
	Worn or defective parts	Contact Dealer
Pump has stopped	Lower than operating water level has caused pump to overheat	Increase operating water level or pump cooler water

## 2-YEAR LIMITED WARRANTY

MONDI warrants to the original consumer purchaser ("Purchaser") of its products that they are free from defects in material or workmanship. If within twenty-four (24) months from the date of the original consumer purchase any such product shall prove to be defective, it shall be repaired or replaced at MONDI's option, subject to the terms and conditions described below. The original purchase receipt is required to be eligible for warranty. TERMS AND CONDITIONS Purchaser must pay shipping charges necessary to replace product covered by this warranty. This warranty shall not apply to natural acts or disasters such as but not limited to: lightning, power surges, flash flooding, earthquake, nor shall it apply to products which in the sole judgement of MONDI, have been subjected to negligence, abuse, accident, misapplication, tampering, alteration; nor due to improper installation, operation, maintenance, or storage; nor to other than normal application, use or service, including but not limited to, operational failures caused by corrosion, rust or other foreign materials in the system, or operation at pressures in excess of recommended maximums. Requests for service under this warranty shall be made by returning the defective product to the location of purchase or to MONDI as soon as possible after the discovery of any alleged defect. MONDI will subsequently take corrective action as promptly as reasonably possible. No requests for service under this warranty will be accepted if received more than 30 days after the term of this warranty. This warranty sets forth MONDI's sole obligation and purchaser's exclusive remedy for defective products. MONDI SHALL NOT BE RESPONSIBLE FOR ANY CONSEQUENTIAL, INCIDENTAL, OR CONTINGENT DAMAGES WHATSOEVER. THE FOREGOING WARRANTIES ARE EXCLUSIVE AND IN LIEU OF ALL OTHER EXPRESS WARRANTIES. IMPLIED WARRANTIES, INCLUDING BUT NOT LIMITED TO THE IMPLIED WARRANTIES OF MERCHANTABILITY AND FITNESS FOR A PARTICULAR PURPOSE, SHALL NOT EXTEND BEYOND THE DURATION OF THE APPLICABLE EXPRESS WARRANTIES PROVIDED HEREIN. Some states in the U.S.A. do not allow the exclusion or limitation of incidental or consequential damages or limitations on how long an implied warranty lasts, so the above limitations or exclusions may not apply to you. This warranty gives you specific legal rights and you may have other rights which vary between provinces and states.

EXPANDED VIEW

The following diagram is for your reference to operate and clean your MONDI Utility Sump Pump. Do not open the motor housing - you will void your warranty.

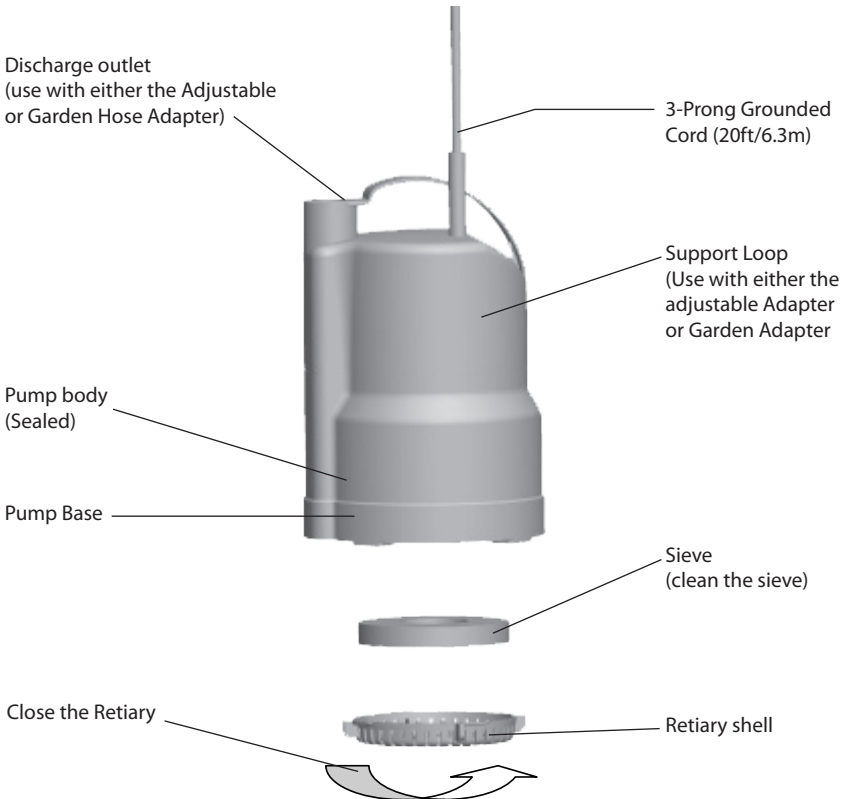

**NOTE: DO NOT OPEN THE MOTOR HOUSING!**  
**DOING SO VOIDS YOUR WARRANTY.**



[WWW.MONDIPRODUCTS.COM](http://WWW.MONDIPRODUCTS.COM)

**888-88 MONDI**

COPYRIGHT 2004

**MONDI PRODUCTS LTD.**

MONDI™ IS USED UNDER LICENSE