

**DOSATRON**®

WATER POWERED DOSING TECHNOLOGY

8

Remove the plastic casing\*\* from Monitor pH probe and follow calibration instructions provided by BlueLab.

Reducer for pH probe is found in the blue lab box.

Attach both probes to the bottom of the two Tees as shown.

For more details see the Monitor instructions.

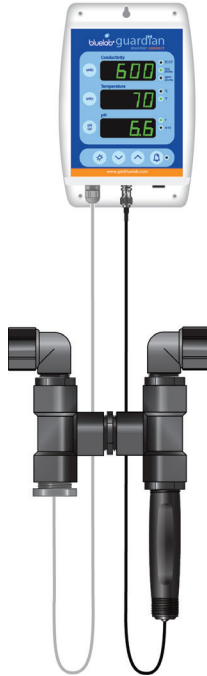

Questions? Call **800-523-8499**.

**Exclusively distributed by:**



**Sunlight Supply, Inc.**

National Garden Wholesale.

[www.sunlightsupply.com](http://www.sunlightsupply.com)

2016-05 PF NDS-Monitor Assembly Kit

# Nutrient Delivery System

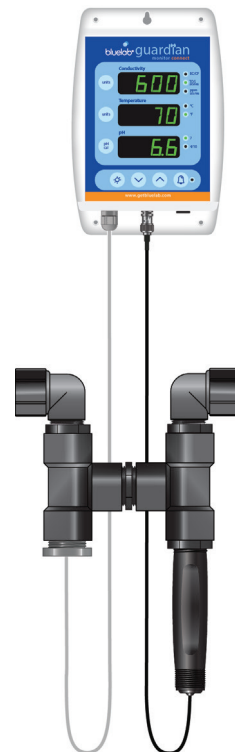

**Monitor  
Assembly Kit  
Part #: 709014**

# Monitor Assembly Kit

## Step-by-Step Assembly Instructions

1

Wrap all the threaded ends of the parts in the kit with **Teflon®** tape\*.

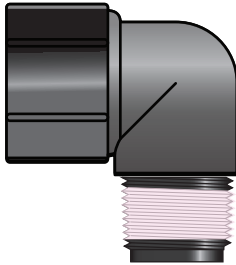

2

Install **Elbow** on the **Reducer Bushing**.

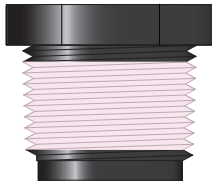

3

Connect the **1" Tee** to the **Reducer Bushing**.

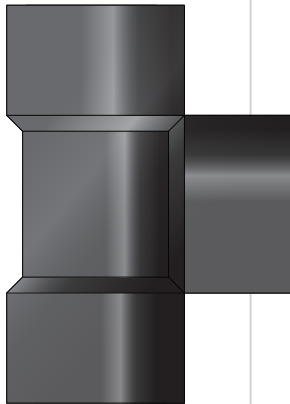

4

Install the **1" Nipple** to the center of the **Tee**.

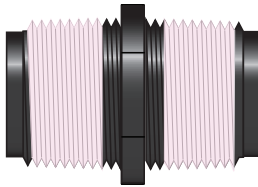

5

Attach the other **1" Tee** to the right side of the **1" Nipple**.

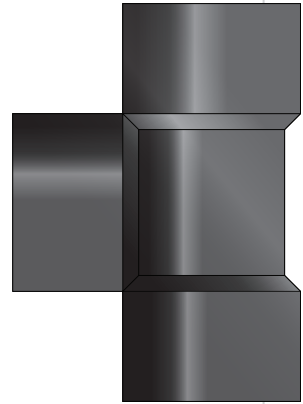

6

Install a **1" Reducer Bushing** on both the top and bottom of the **1" Tee**.

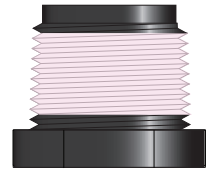

7

Insert an **Elbow** into the **Reducing Bushing**.

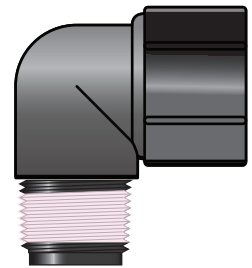

### Kit Includes:

- 2 - Elbows
- 1 - 1" Nipple
- 2 - 1" Tees
- 2 - 1" to 3/4" Reducer Bushings
- 1 - Monitor
- 1 - Roll Pink Teflon® tape

\* Wrap 3-4 turns of the pink Teflon® tape included in your kit. If you are using white Teflon® tape, wrap 6-8 turns. To wrap, hold the part in your left hand and wrap the Teflon® tape clockwise.

Monitor Assembly includes parts listed.  
Dosatron injector sold separately.